

NOTE:
NO CONSTRUCTION FOR THIS PLAN IS ANTICIPATED WITHIN THE EXISTING RIGHT-OF-WAY OF 132ND ST. S.E. IMPROVEMENTS WITHIN 132ND ST. S.E. SHOWN HEREON ARE AS PROPOSED TO BE CONSTRUCTED BY SNOHOMISH COUNTY DEPARTMENT OF PUBLIC WORKS, PROJECT NO. 90-984 "132ND STREET S.E. SR 527 TO 35TH AVE. S.E."

CLEANOUT/YARD DRAIN SCHEDULE

LOT NO.	TOP	INV.	TYPE	REMARKS
1	409.8	407.8	C.O.	MIN. CRAWL SPACE ELEV. 408.1
2	410.2	408.2	C.O.	MIN. CRAWL SPACE ELEV. 408.1
3	410.82	408.82	Y.D.	
4	412.30	410.30	Y.D.	
5	416.72	414.72	Y.D.	
6	423.17	421.17	Y.D.	
7	418.27	416.27	Y.D.	
8	420.22	418.22	Y.D.	
9	423.21	421.21	Y.D.	
10	425.25	423.25	C.O.	
11	425.27	423.27	C.O.	
12	425.32	423.32	C.O.	
13	418.2	416.2	Y.D.	
14	415.2	413.2	Y.D.	
15	410.48	408.48	Y.D.	
16	409.89	407.89	C.O.	
17	411.84	409.84	Y.D.	
18	415.28	413.28	Y.D.	
19	415.22	413.22	Y.D.	
20	412.22	410.22	Y.D.	
21	412.04	410.04	Y.D.	
22	416.11	414.11	Y.D.	MIN. CRAWL SPACE ELEV. 414.0
23	416.2	414.2	Y.D.	MIN. CRAWL SPACE ELEV. 414.0
24	419.27	417.27	Y.D.	
25	418.2	416.2	Y.D.	
26	422.2	420.2	Y.D.	
27	421.27	419.27	Y.D.	
28	421.26	419.26	Y.D.	
29	418.2	416.2	Y.D.	
30	418.28	416.28	C.O.	MIN. CRAWL SPACE ELEV. 416.7
31	416.2	414.2	Y.D.	FDN. DRAIN TO TRACT 998
32	416.46	414.46	Y.D.	FDN. DRAIN TO TRACT 998
33	416.2	414.2	Y.D.	
34	416.2	414.2	Y.D.	
35	416.2	414.2	Y.D.	MIN. CRAWL SPACE ELEV. 416.7
36	416.2	414.2	C.O.	

RECORD DRAWING DECLARATION
 I HEREBY DECLARE THAT THE ROAD AND STORM DRAINAGE IMPROVEMENTS ARE LOCATED AS SHOWN ON THESE RECORD DRAWINGS.
 BY: *[Signature]* DATE: 8/18/94
 PROJECT ENGINEER/SURVEYOR
 BY: *[Signature]* DATE: 8/19/94
 PLAT DEVELOPER/OWNER

- LEGEND**
- + SET CASED CONCRETE MONUMENT PER SNOHOMISH COUNTY STANDARDS
 - SET 1" X 24" IRON PIPE WITH PLASTIC CAP NUMBERED 12095 AND 12969
 - ⊙ FOUND CASED CONCRETE MONUMENT

- SPECIAL DRAINAGE NOTES FOR HOUSE CONSTRUCTION:**
- ALL ROOF DRAINS AND DRIVEWAY SURFACES SHALL BE CONSTRUCTED TO DRAIN TO THE DETENTION SYSTEM.
 - IF FOUNDATION DRAINS ARE LESS THAN 6-INCHES HIGHER THAN THE DETENTION SYSTEM OVERFLOW, THEY SHALL BYPASS THE DETENTION SYSTEM. ANY FOUNDATION DRAIN MAY BYPASS THE DETENTION SYSTEM BY DAYLIGHTING AT THE GROUND SURFACE AT A LOWER ELEVATION OR BY PIPE CONNECTION TO A LOWER PORTION OF THE DRAINAGE SYSTEM.
 - ANY GROUND SURFACE RELEASE OF FOUNDATION DRAINAGE SHALL BE AT A LOCATION WHICH DRAINS IMMEDIATELY TO THE DRAINAGE SYSTEM OR TO THE NATURAL WATERCOURSE WITHOUT AFFECTING OTHER LOTS.

NATIVE GROWTH/WILDLIFE HABITAT PROTECTION AREA (N.G./W.H.P.A.)
 (TRACTS 997, 998, AND 999 INCLUSIVE)
 "ALL NATIVE GROWTH/WILDLIFE HABITAT PROTECTION AREAS SHALL BE LEFT IN A SUBSTANTIALLY NATURAL STATE. NO CLEARING, GRADING, FILLING, BUILDING CONSTRUCTION OR PLACEMENT, FENCE CONSTRUCTION, OR ROAD CONSTRUCTION OF ANY KIND SHALL OCCUR WITHIN THESE AREAS; PROVIDED THAT UNDERGROUND UTILITY LINES AND DRAINAGE DISCHARGE SWALES MAY CROSS SUCH AREAS UTILIZING THE SHORTEST ALIGNMENT POSSIBLE IF AND ONLY IF NO FEASIBLE ALIGNMENT IS AVAILABLE WHICH WOULD AVOID SUCH A CROSSING; AND PROVIDED FURTHER THAT WETLAND MITIGATION/ENHANCEMENT ACTIVITIES ARE EXPRESSLY PERMITTED CONSISTENT WITH CONDITIONS C.VII AND DIV. OF THE HEARING EXAMINER DECISION. REMOVAL OF VEGETATION BY THE PROPERTY OWNER SHALL BE LIMITED TO THAT WHICH IS DEAD, DISEASED OR HAZARDOUS. NO ADJUSTMENT TO THE BOUNDARY OF ANY SUCH AREA SHALL OCCUR UNLESS FIRST APPROVED THROUGH THE FORMAL REPEAT PROCESS."

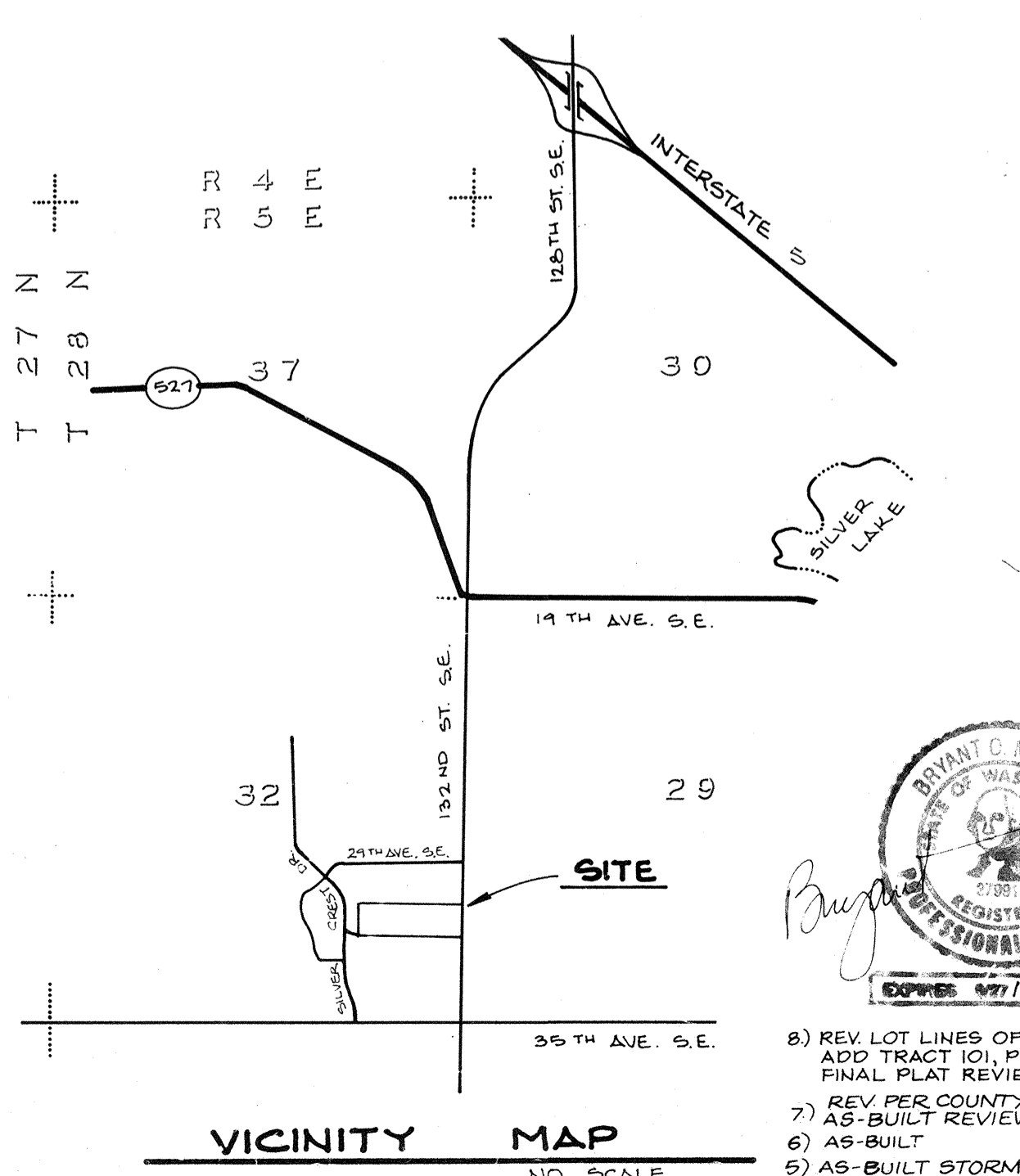

OWNER/DEVELOPER
 B.D.Z. DEVELOPERS, INC.
 14615 N.E. 190TH, SUITE C3
 WOODINVILLE, WA 98072
 TELEPHONE: 206-483-8221

ENGINEER
 LOVELL-SAUERLAND & ASSOCIATES, INC.
 19400 - 33RD AVE. W., SUITE 200
 LYNNWOOD, WA 98036
 TELEPHONE: 206-775-1591

LEGAL DESCRIPTION
 THE EAST HALF OF THE EAST HALF OF THE EAST HALF OF THE NORTHWEST QUARTER OF THE NORTHEAST QUARTER OF SECTION 32, TOWNSHIP 28 NORTH, RANGE 5 EAST, W.M.; EXCEPT ROAD.
 ALSO:
 THE WEST HALF OF THE WEST HALF OF THE WEST HALF OF THE NORTHEAST QUARTER OF SECTION 32, TOWNSHIP 28 NORTH, RANGE 5 EAST, W.M.; EXCEPT COUNTY ROAD 8403 TO COUNTY OF SNOHOMISH UNDER RECORDING NOS. 219642, 8402290222 AND 8403160221.
 ALSO:
 THE WEST HALF OF THE EAST HALF OF THE WEST HALF OF THE WEST HALF OF THE NORTHEAST QUARTER OF SECTION 32, TOWNSHIP 28 NORTH, RANGE 5 EAST, W.M.; EXCEPT ANY PORTION THEREOF LYING WITHIN 132ND STREET SOUTHEAST AND EXCEPT THE NORTH 25 FEET THEREOF AS CONVEYED TO SNOHOMISH COUNTY BY DEED RECORDED UNDER RECORDING NO. 9010290049, A RE-RECORD OF RECORDING NO. 891002022.

SITUATE IN THE COUNTY OF SNOHOMISH, STATE OF WASHINGTON.

BENCHMARK
 ORIGINATING: TOP OF SURFACE MONUMENT AT THE INTERSECTION OF 132ND STREET S.E. AND 35TH AVENUE S.E.
 ELEVATION: 396.56
 TBM: TOP OF CONCRETE MONUMENT IN CASE AT THE INTERSECTION OF 139TH PL. S.E. AND 30TH AVENUE S.E. (EAST EDGE)
 ELEVATION: 423.07

DATUM **CONTOUR INTERVAL**
 USC & GS (MEAN SEA LEVEL) 5 FOOT INTERVALS

35TH AVE. S.E. 32 29
 33 28 EX. SURFACE BRASS DISC

ROAD AND STORM DRAINAGE PLAN FOR SUNSET LANE
 N.E. 1/4, SECTION 32, T. 28 N., R. 5 E., W.M.
 SNOHOMISH COUNTY, WASHINGTON
 SA 9008437 GRADING NO. 692-

BY: *[Signature]* DATE: 8/18/94
 FOR RANDOLPH R. WRIGHT, P.E., P.L.S.
 RAW PERMIT NO. RW1377

SNOHOMISH COUNTY COMMUNITY DEVELOPMENT DIVISION APPROVED FOR CONSTRUCTION

LSA Lovell-Sauerland & Associates, Inc.
 Engineers/Surveyors/Planners/Development Consultants
 19400 33rd Avenue W., Suite 200 • Lynnwood, WA 98036 • (206) 775-1591 • (206) 340-0830

7/10/93 BM
 3/22/93 BM
 1/4/93 BM
 3/19/93 BM
 8/5/92

8) REV. LOT LINES OF LOTS 24-30, ADD TRACT 101, PER COUNTY FINAL PLAT REVIEW 10-3-94 KM
 7) REV. PER COUNTY 9-26-94 RCN
 6) AS-BUILT REVIEW 8-18-94 RCN
 5) AS-BUILT STORM DRAINS IN PAVED AREAS 8-30-94 RCN

4) REV. PER COUNTY REVIEW 7-14-93 CB
 3) REV. PER COUNTY REVIEW 6-22-93 RCN
 2) REV. PER APPROVED PLAT MODIFICATION 4-14-93 KM
 1) MOVED DET. POND & REV. PER COUNTY REVIEW 3-18-93 RCN

LSA 37B SCALE 1" = 50' FILE NO. 2302.01

AS-BUILT SUNSET LANE HDEV-2151 SHEET 1 OF 6

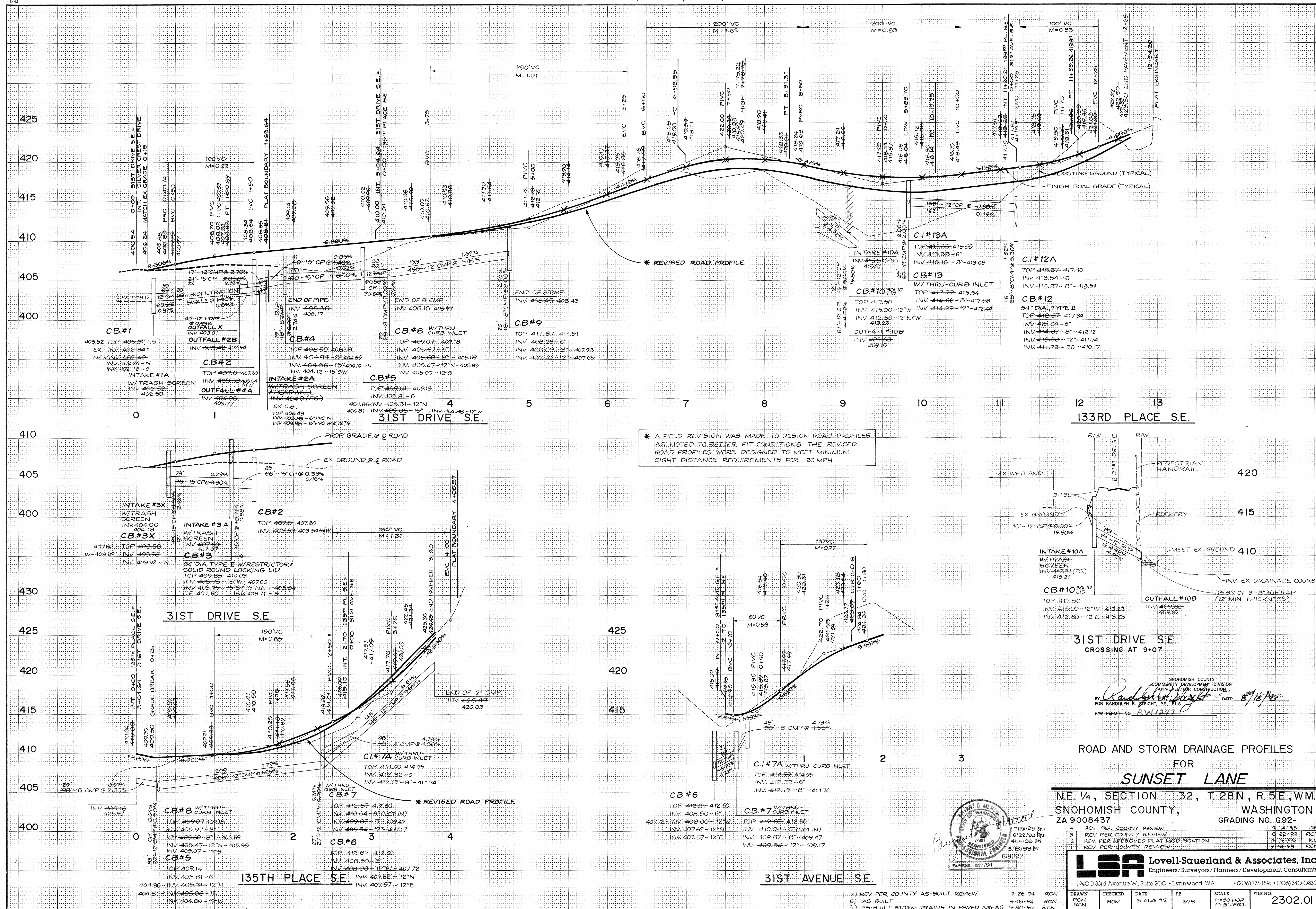

* A FIELD REVISION WAS MADE TO DESIGN ROAD PROFILES AS NOTED TO BETTER FIT CONDITIONS. THE REVISED ROAD PROFILES WERE DESIGNED TO MEET MINIMUM SIGHT DISTANCE REQUIREMENTS FOR 20 MPH.

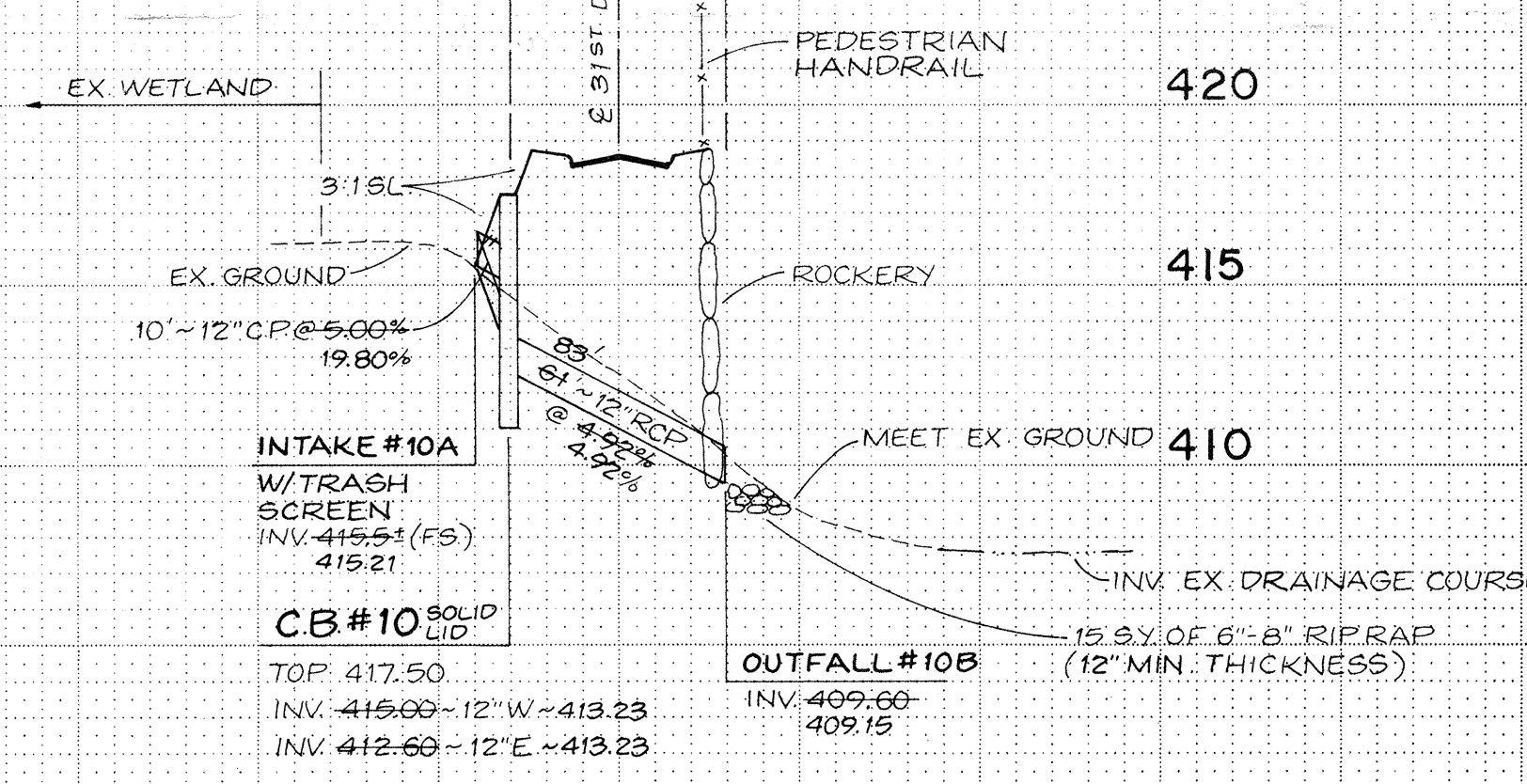

31ST DRIVE S.E. CROSSING AT 9+07

SNOWHISH COUNTY COMMUNITY DEVELOPMENT DIVISION
 APPROVED FOR CONSTRUCTION
 BY: *Randolph R. Wright*
 FOR RANDOLPH R. WRIGHT, P.E., ELS. DATE: 8/16/92
 RAW PERMIT NO. RW1277

ROAD AND STORM DRAINAGE PROFILES FOR SUNSET LANE

N.E. 1/4, SECTION 32, T. 28 N., R. 5 E., W.M.
 SNOWHISH COUNTY, WASHINGTON
 ZA 9008437 GRADING NO. 692-

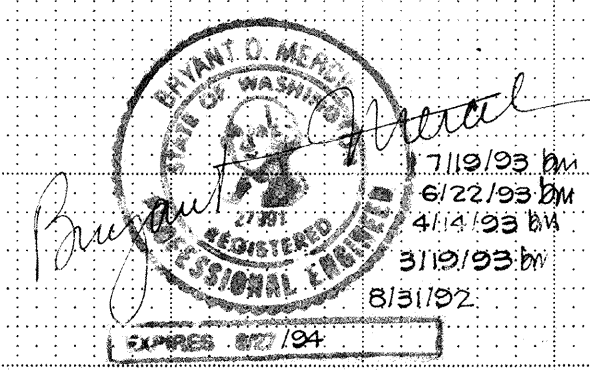

1	REV. PER COUNTY REVIEW	7-14-92	RCN
2	REV. PER COUNTY REVIEW	6-22-93	RCN
3	REV. PER APPROVED PLAT MODIFICATION	4-14-93	KM
4	REV. PER COUNTY REVIEW	3-18-93	RCN

LSA Lovell-Sauerland & Associates, Inc.
 Engineers / Surveyors / Planners / Development Consultants
 19400 33rd Avenue W., Suite 200 • Lynnwood, WA • (206) 775-1591 • (206) 340-0830

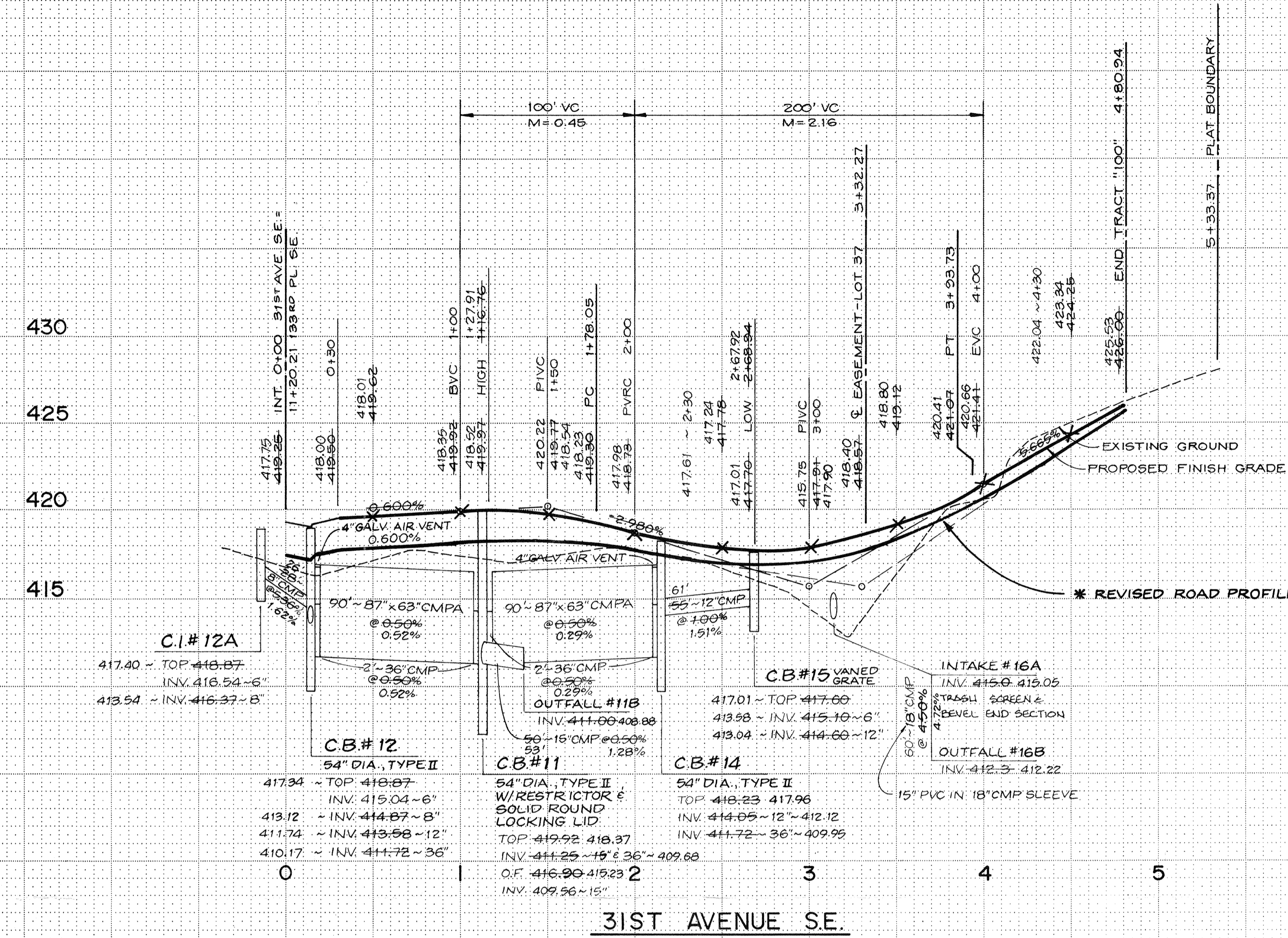

DETENTION VOLUMES
 REQUIRED VOLUME - 5,852 C.F.
 AS-BUILT VOLUME - 5,852 C.F.

SNHOMISH COUNTY
 COMMUNITY DEVELOPMENT DIVISION
 APPROVED FOR CONSTRUCTION
 BY *Randolph R. Slight* DATE: 8/18/93
 FOR RANDOLPH R. SLIGHT, P.E., P.L.S.
 RAW PERMIT NO. RW1277

ROAD AND STORM DRAINAGE PROFILES

FOR
SUNSET LANE

N.E. 1/4, SECTION 32, T. 28 N., R. 5 E., W.M.
 SNHOMISH COUNTY, WASHINGTON
 ZA 9008437 GRADING NO. 692-

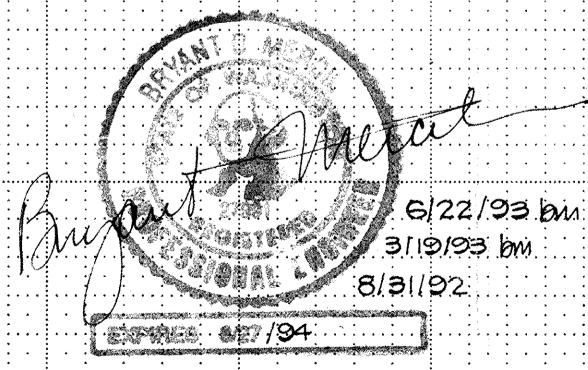

4	AS-BUILT	8-18-94	RCN
3	AS-BUILT STORM DRAINS IN PAVED AREAS	3-30-94	RCN
2	REV PER COUNTY REVIEW	6-22-93	RCN
1	REV PER COUNTY REVIEW	3-18-92	RCN

LSA Lovell-Sauerland & Associates, Inc.
 Engineers/Surveyors/Planners/Development Consultants
 19400 33rd Avenue W., Suite 200 • Lynnwood, WA • (206) 775-1591 • (206) 340-0830

DRAWN PCM RCN	CHECKED BOM	DATE 31 AUG 92	FB 378	SCALE 1"=50' HOR. 1"=5' VERT.	FILE NO. 2302.01
---------------------	----------------	-------------------	-----------	-------------------------------------	---------------------

- GENERAL NOTES**
- LOCATIONS OF EXISTING UTILITIES AND IMPROVEMENTS SHOWN ARE APPROXIMATE ONLY AND IT SHALL BE THE RESPONSIBILITY OF THE CONTRACTOR TO DETERMINE THE EXACT LOCATIONS OF ALL UTILITIES AND IMPROVEMENTS TO AVOID DAMAGE OR DISTURBANCE.
 - FOR AID IN UTILITY LOCATION CALL 1-800-424-5555 PRIOR TO BEGINNING CONSTRUCTION.
 - THE CONTRACTOR SHALL BE RESPONSIBLE FOR OBTAINING ALL PERMITS FOR ROAD AND UTILITY CONSTRUCTION.
 - ALL WORK AND MATERIALS SHALL BE IN ACCORDANCE WITH SNOHOMISH COUNTY STANDARDS AND SPECIFICATIONS AND WASHINGTON STATE DEPARTMENT OF TRANSPORTATION 1991 STANDARD SPECIFICATIONS FOR ROAD, BRIDGE, AND MUNICIPAL CONSTRUCTION AND THE 1989 WOOD HYDRAULICS MANUAL.
 - ALL WORK WITHIN THE SITE AND COUNTY RIGHT-OF-WAY SHALL BE SUBJECT TO THE INSPECTION OF THE COUNTY INSPECTOR OR HIS DESIGNATED REPRESENTATIVE.
 - PRIOR TO ANY SITE CONSTRUCTION TO INCLUDE CLEARING/LOGGING OR GRADING THE SITE/LOT CLEARING LIMITS SHALL BE LOCATED AND FIELD IDENTIFIED BY THE PROJECT SURVEYOR/ENGINEER AS REQUIRED BY THESE PLANS. THE PROJECT SURVEYOR/ENGINEER'S NAME AND TELEPHONE NUMBER ARE LOVELL SAUERLAND & ASSOCIATES, INC. 775-1591.
 - THE DEVELOPER/PROJECT ENGINEER IS RESPONSIBLE FOR WATER QUALITY AS DETERMINED BY THE MONITORING PROGRAM, ESTABLISHED BY THE PROJECT ENGINEER. THE PROJECT ENGINEER'S NAME AND PHONE NUMBER ARE LOVELL SAUERLAND & ASSOCIATES, INC. 775-1591.
 - PRIOR TO ANY SITE WORK, THE CONTRACTOR SHALL CONTACT THE CHIEF INSPECTOR FOR LAND DEVELOPMENT DIVISION AT (206) 388-3336 TO SCHEDULE A PRECONSTRUCTION CONFERENCE DUE TO FIELD CHANGES (REVISIONS). ENGINEER AS-BUILTS SHALL BE REQUIRED PRIOR TO SITE APPROVAL.
 - THE TEMPORARY EROSION/SEDIMENTATION CONTROL FACILITY SHALL BE CONSTRUCTED PRIOR TO ANY GRADING OR EXTENSIVE LAND CLEARING IN ACCORDANCE WITH THE APPROVED TEMPORARY EROSION/SEDIMENTATION CONTROL PLAN. THESE FACILITIES MUST BE SATISFACTORILY MAINTAINED UNTIL CONSTRUCTION AND LANDSCAPING IS COMPLETED AND THE POTENTIAL FOR ON-SITE EROSION HAS PASSED.
 - TRENCH BACK FILL OF NEW UTILITIES AND STORM DRAINAGE FACILITIES SHALL BE COMPACTED TO 95% MAXIMUM DENSITY (MODIFIED PROCTOR) UNDER ROADWAYS AND 90% MAXIMUM DENSITY (MODIFIED PROCTOR) OF ROADWAYS AS SPECIFIED IN SECTION 2-03.3141C COMPACTING EARTH EMBANKMENTS METHOD B.
 - NON COMPLIANCE WITH THE EROSION CONTROL REQUIREMENTS, WATER QUALITY REQUIREMENTS AND CLEARING LIMITS VIOLATIONS MAY RESULT IN REVOCATION OF PROJECT PERMITS, PLAN APPROVAL AND BOND FORFEITURES.

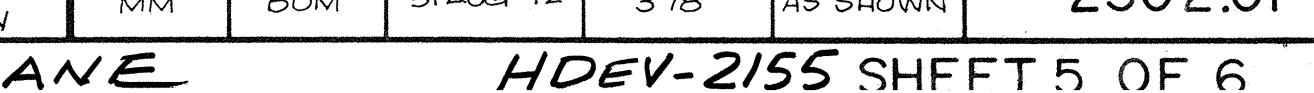
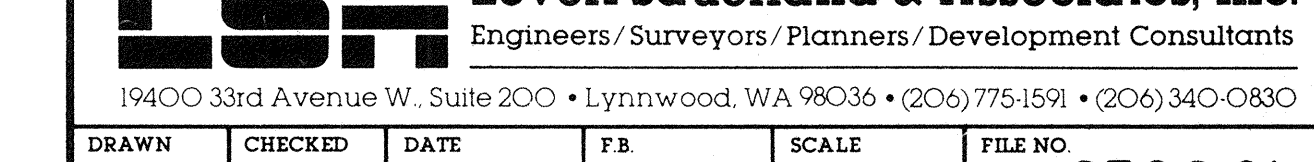
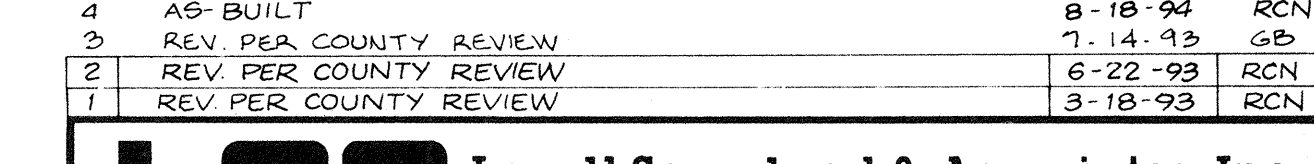
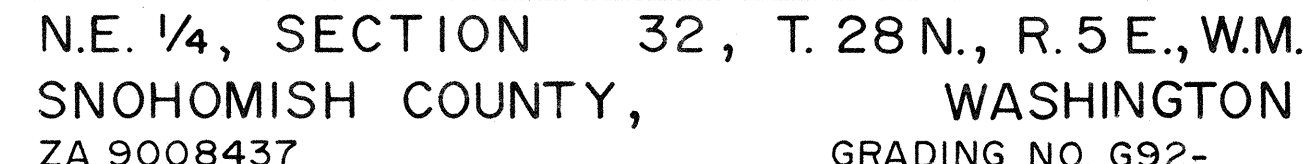
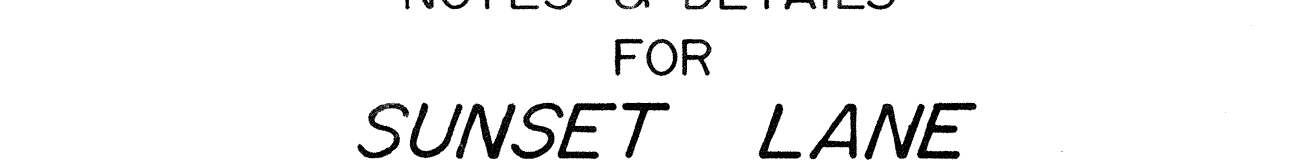
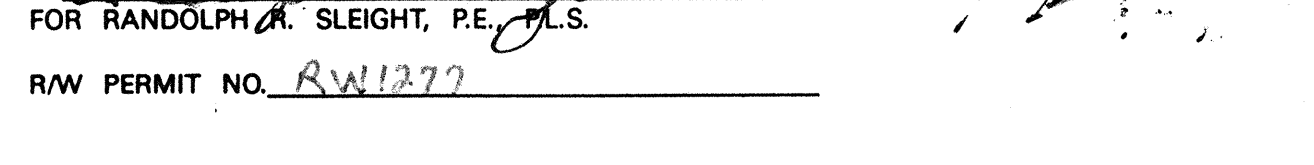
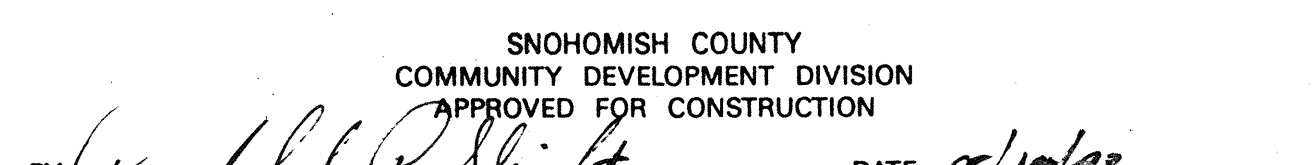
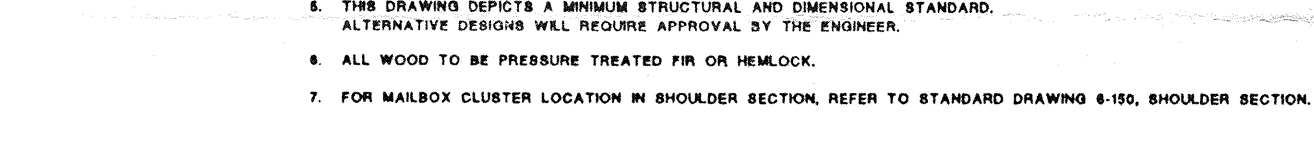
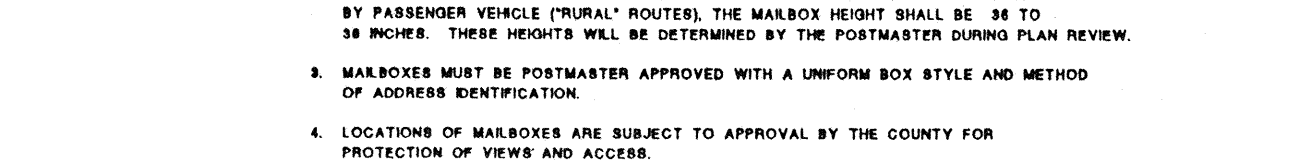
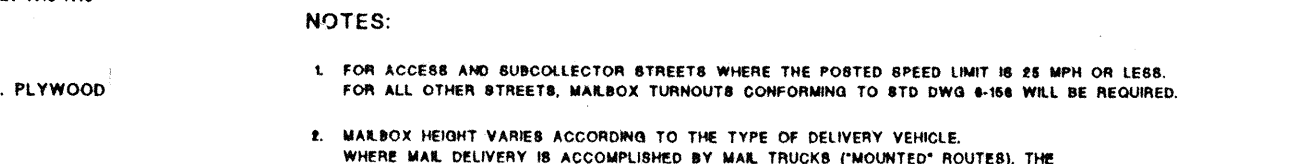
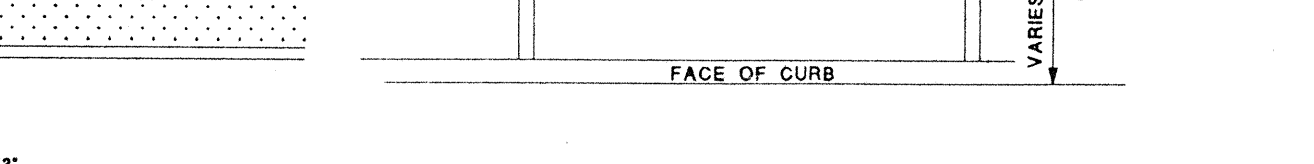
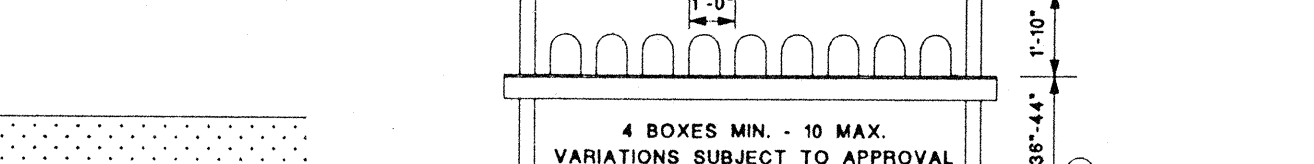
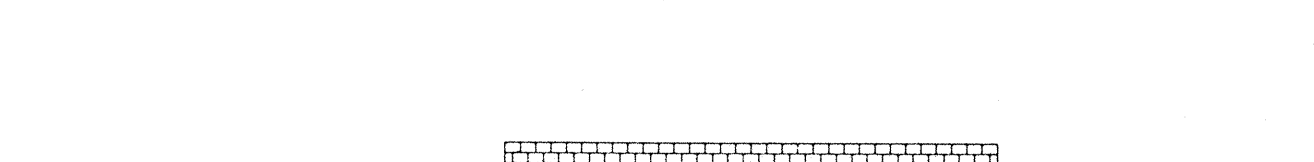
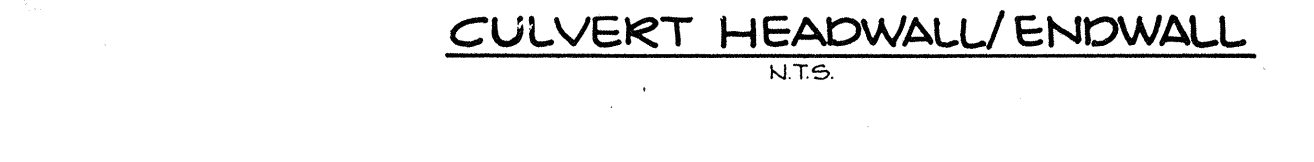
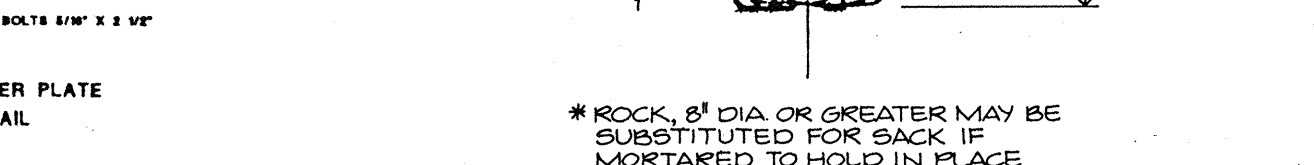
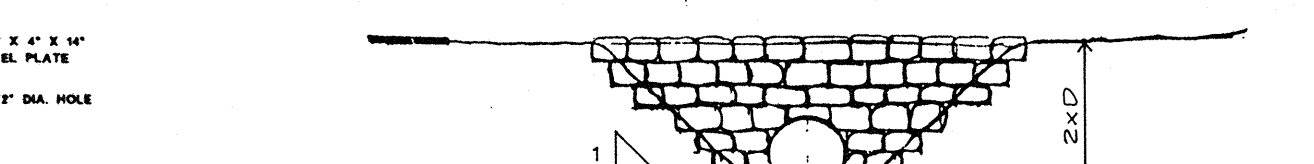
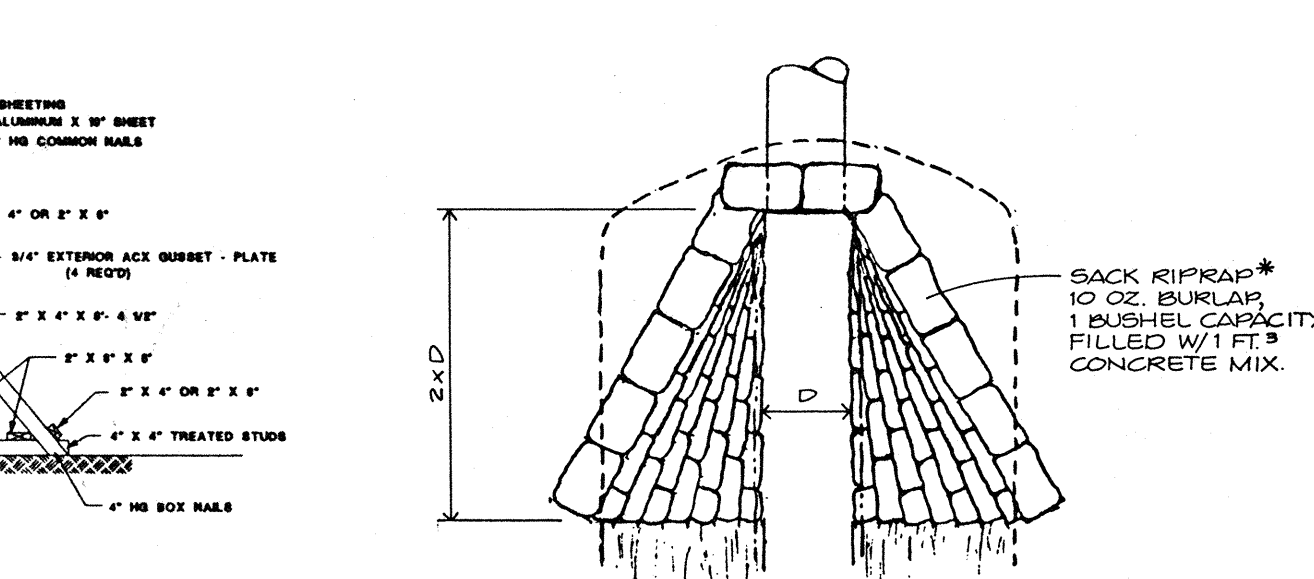
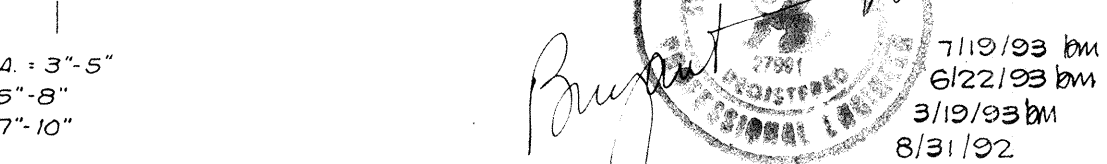
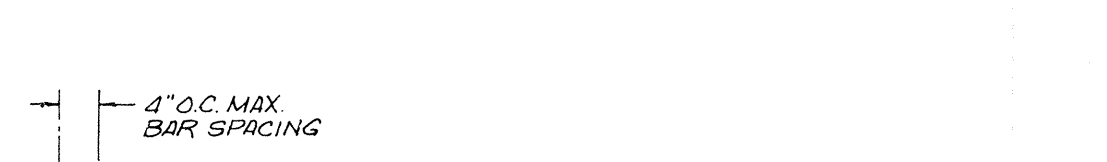
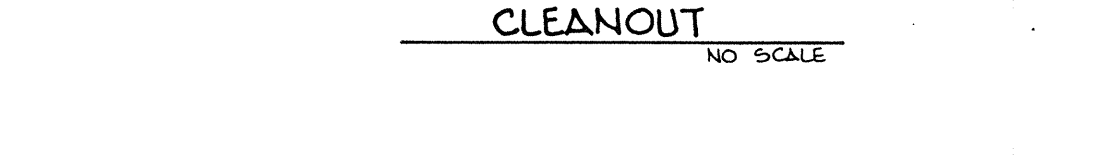
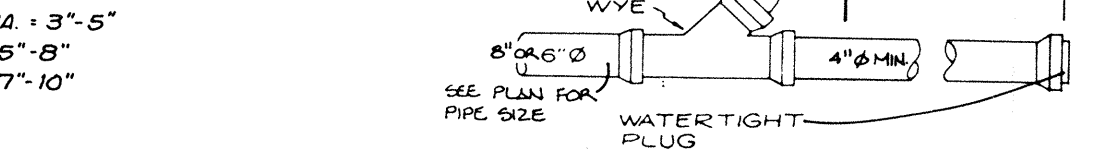
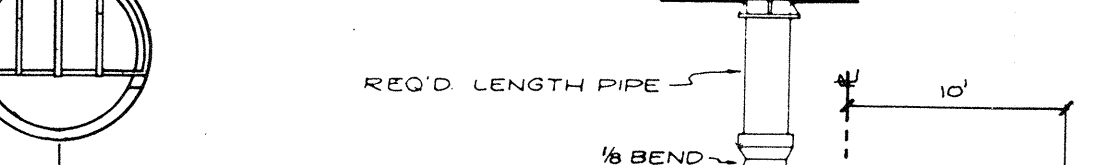
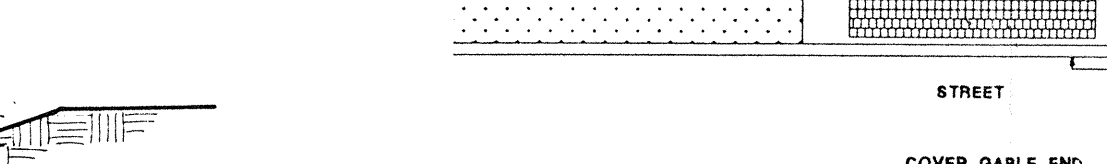
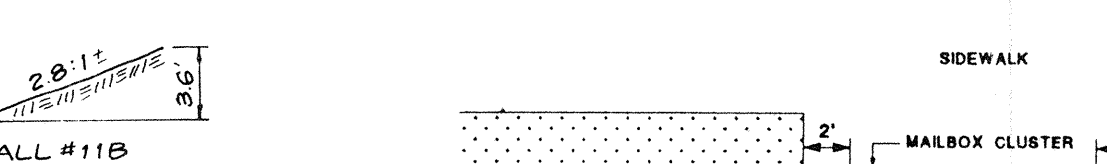
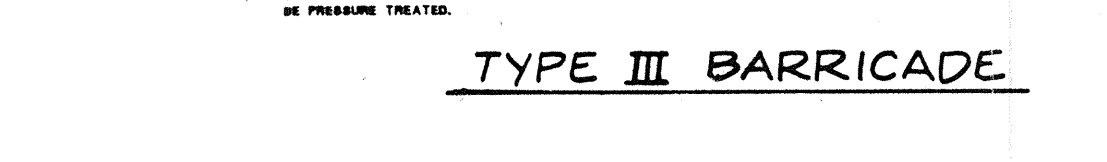
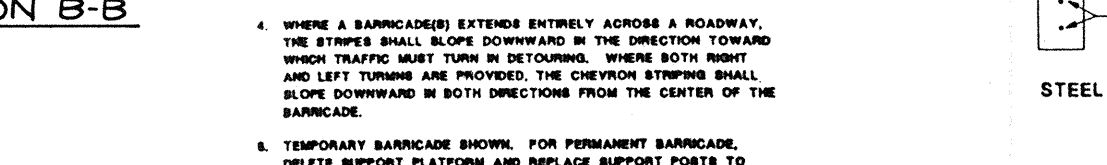
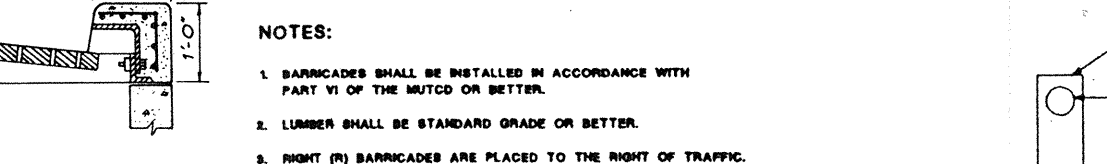
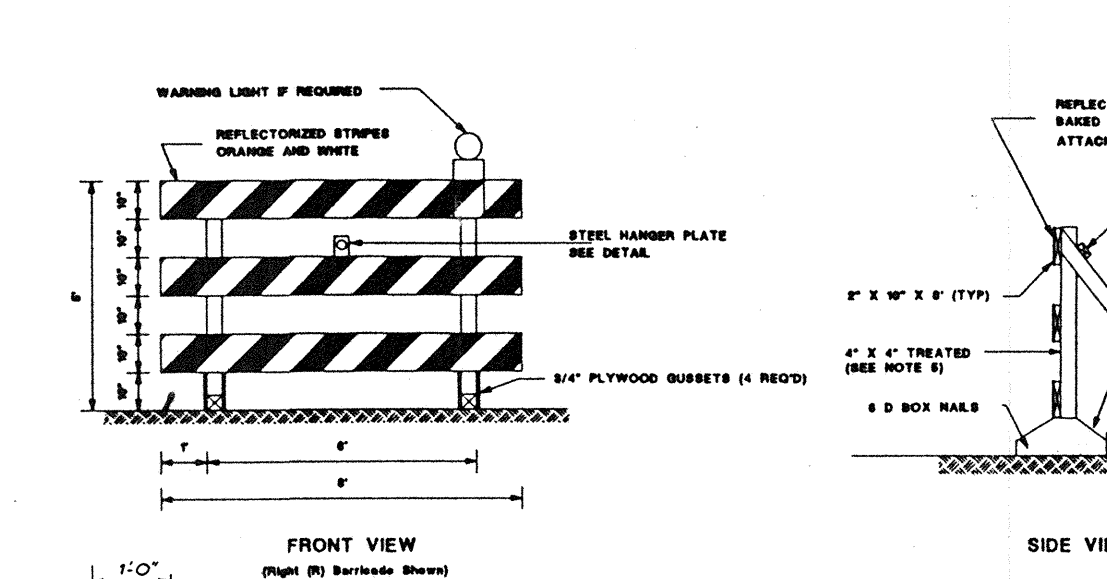
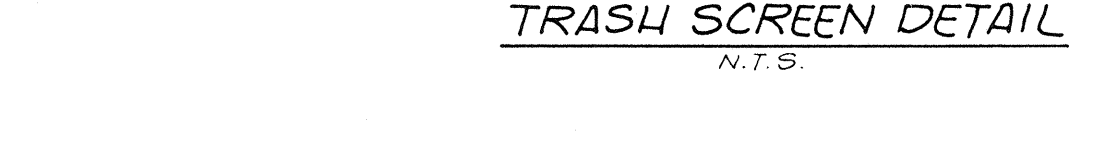
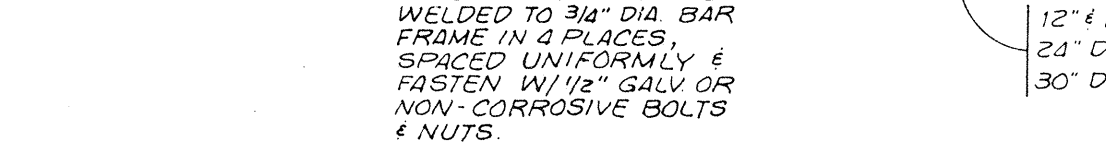
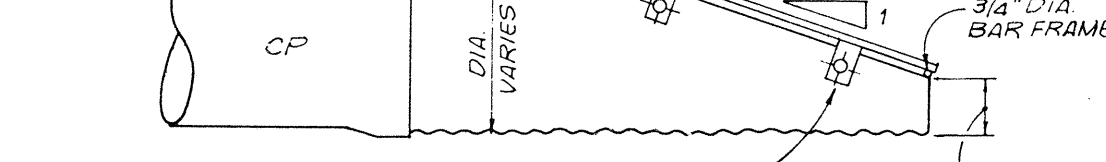
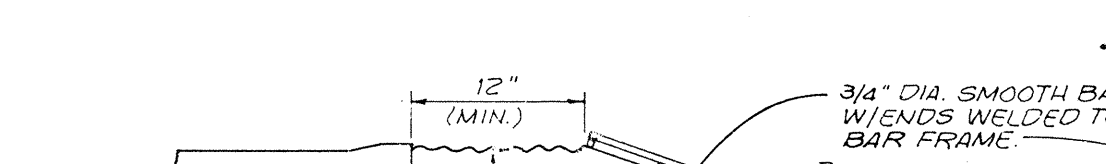
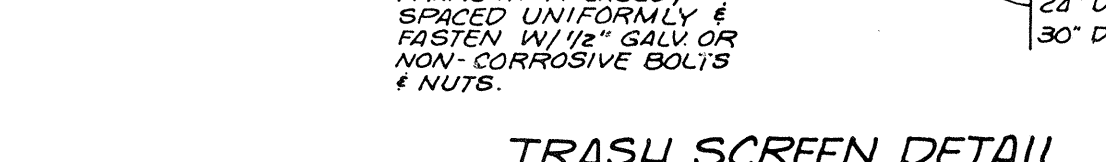
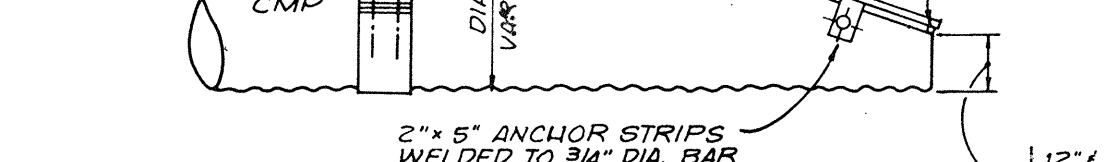
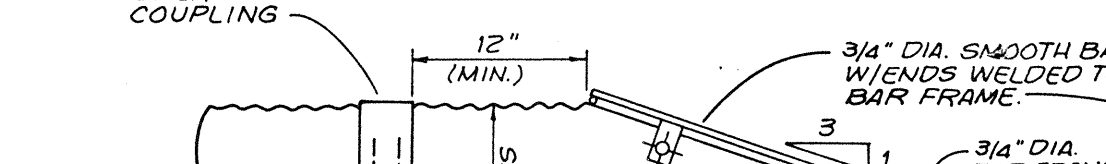
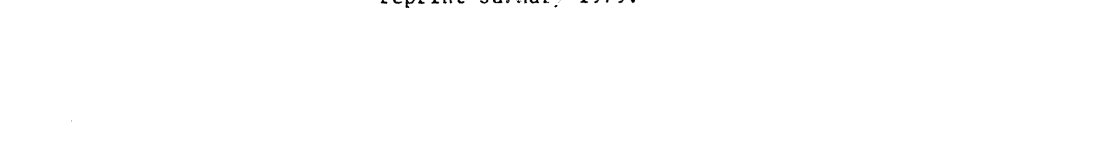
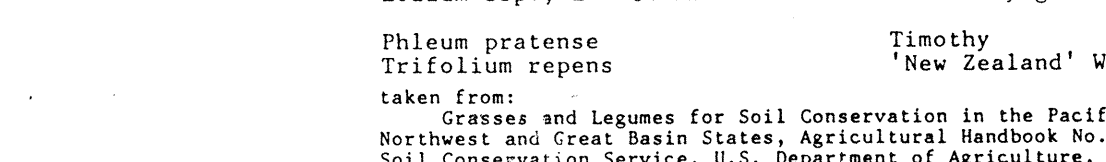
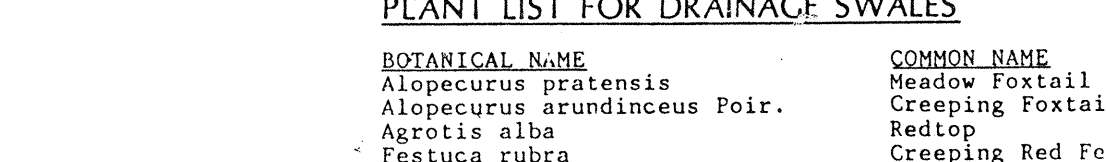
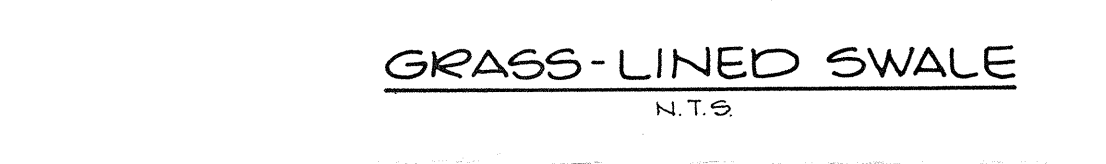
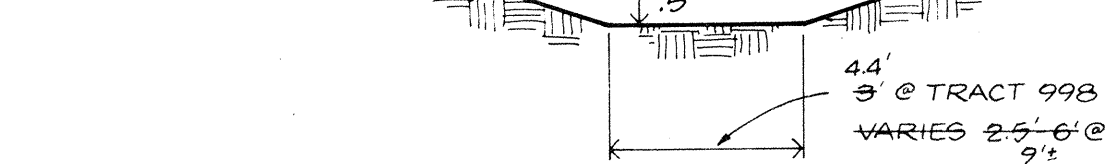
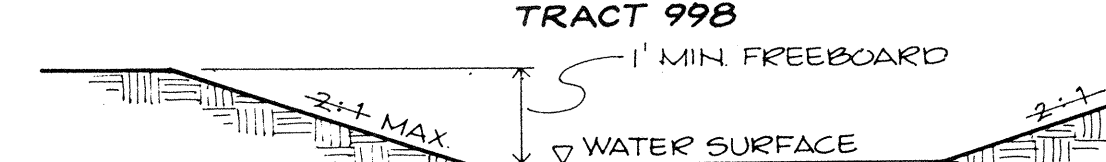
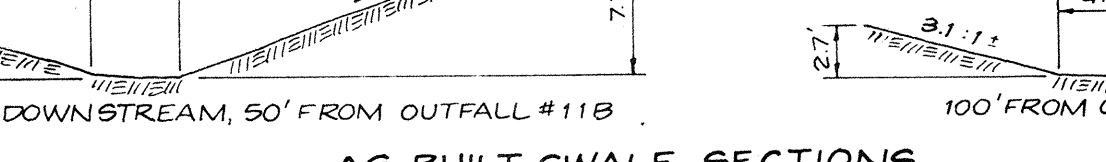
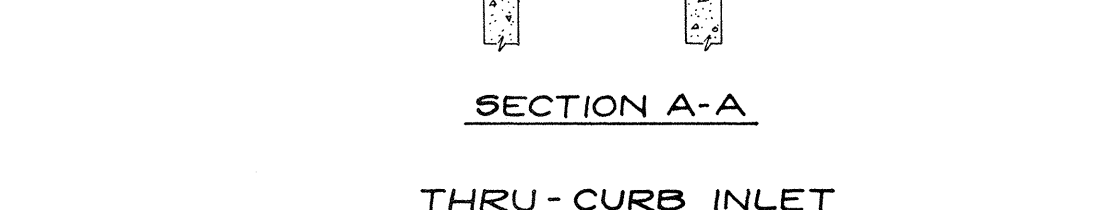
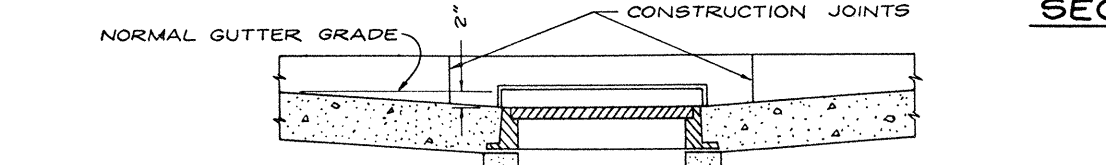
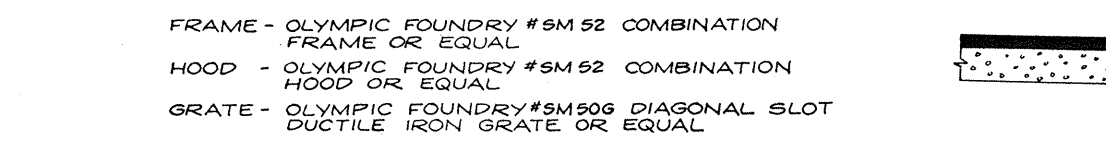
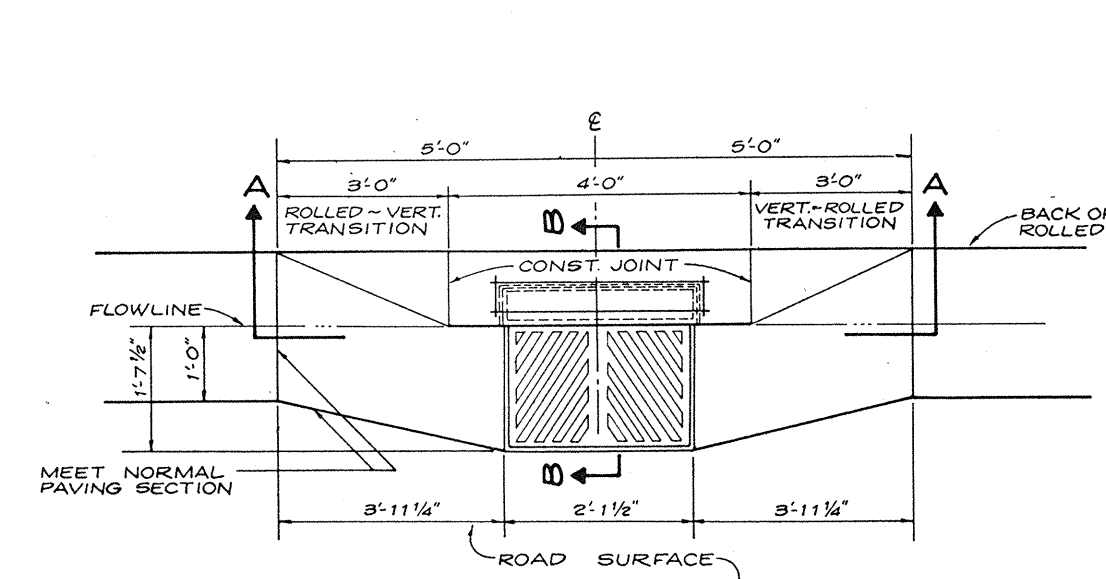
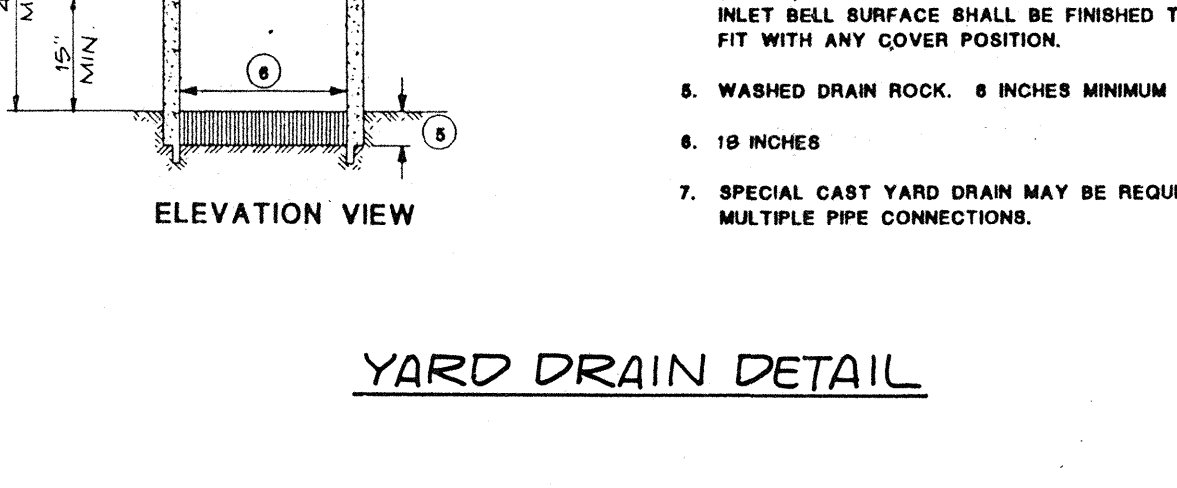
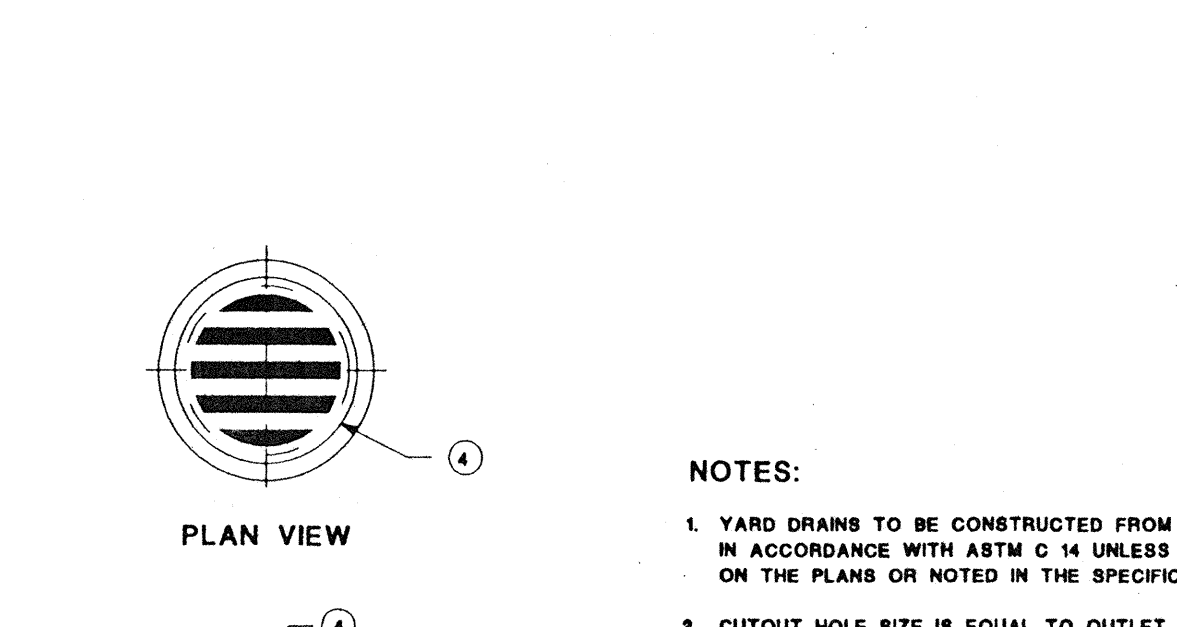
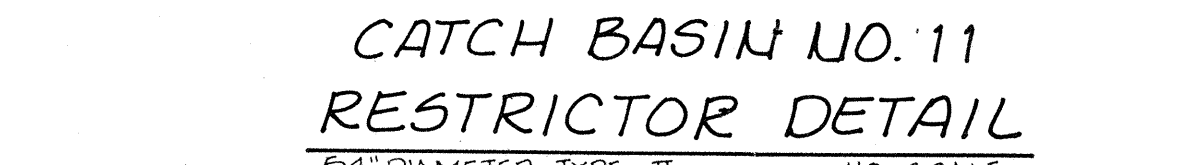
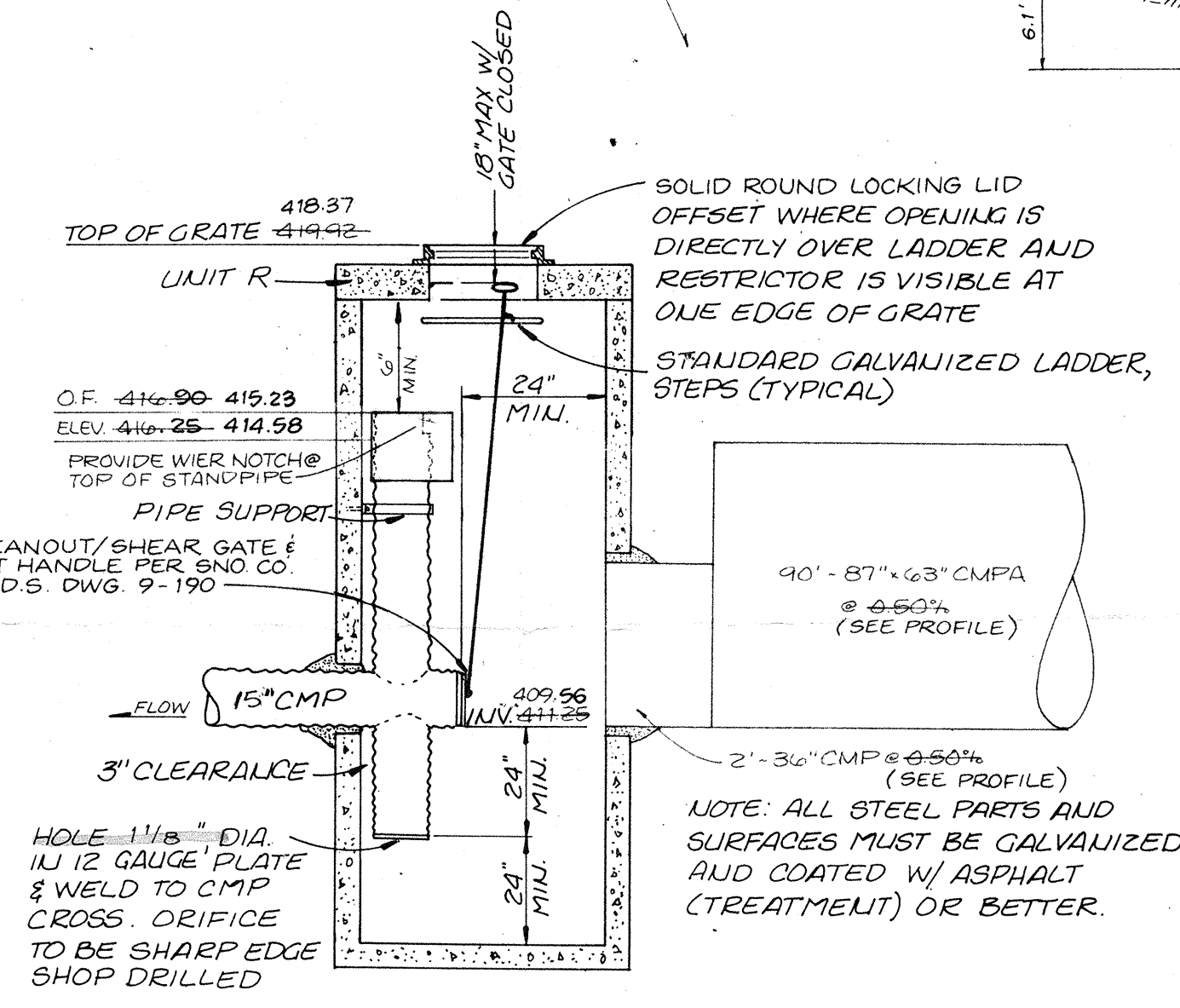
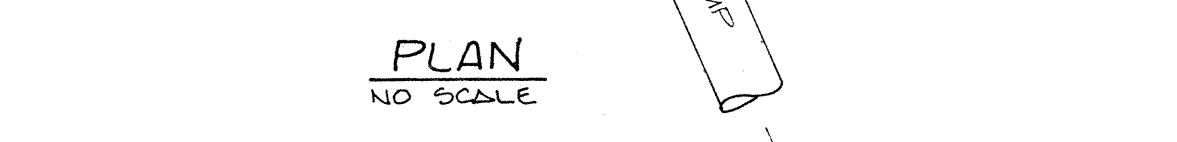
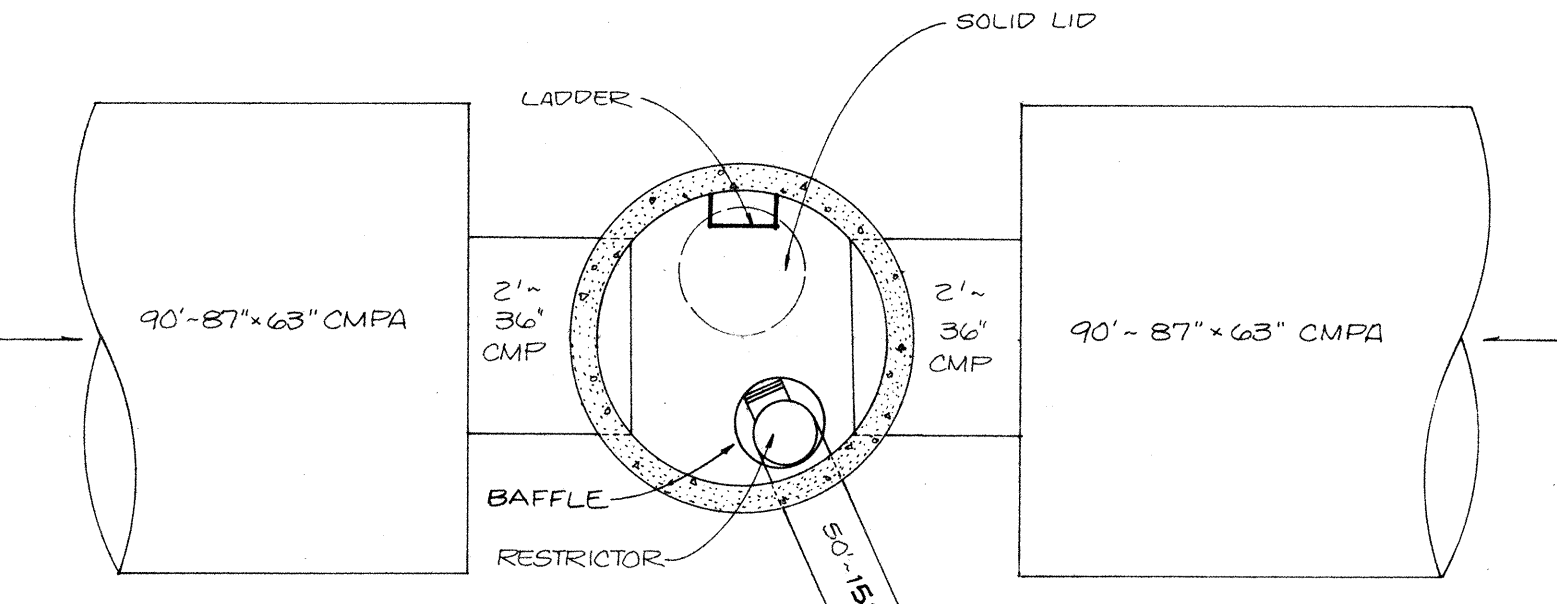
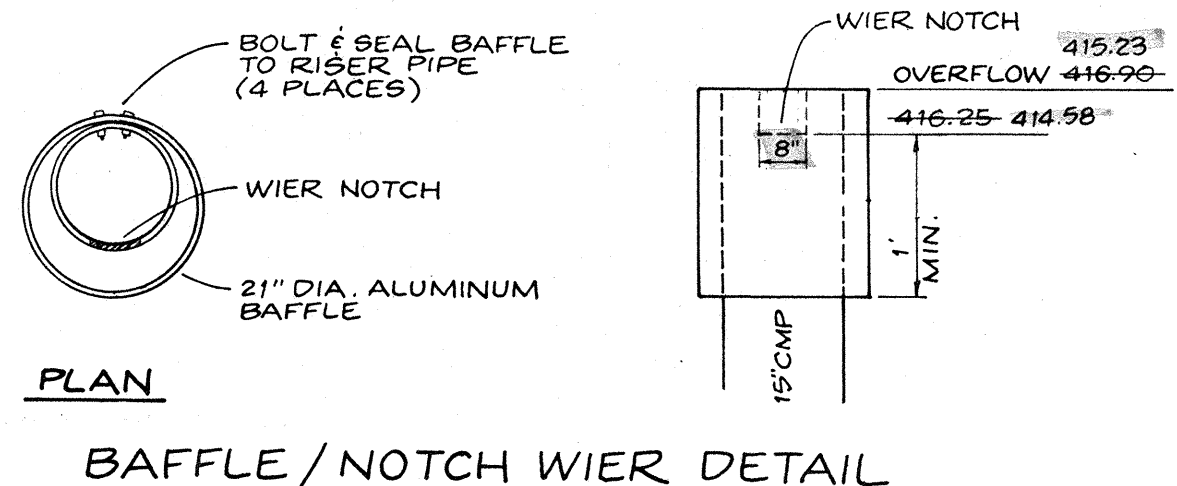

- STORM DRAINAGE NOTES**
1. ALL STORM DRAIN PIPE MAY BE CONSTRUCTED OF ONE OF THE FOLLOWING MATERIALS UNLESS OTHERWISE SPECIFIED IN THE PLANS. ALL PIPE JOINTS MUST BE GASKETED WATER-TIGHT AND MUST BE OF THE SAME MATERIAL AS THE PIPE. ALL PIPE SHALL HAVE A MINIMUM COVER AS SHOWN BELOW AND SHALL BE ADEQUATELY PROTECTED DURING CONSTRUCTION REFER TO THE MANUFACTURER'S RECOMMENDATIONS FOR MINIMUM COVER FOR HEAVY EQUIPMENT LOADINGS.
- *COVER REQUIREMENTS FOR 18" OR SMALLER PIPE**
- < 1.0' - REQUIRES RCP (REINFORCED CONCRETE PIPE) MINIMUM
 - 1.0' - 1.5' - REQUIRES CP (CONCRETE PIPE) MINIMUM
 - > 1.5' - REQUIRES 16 GAUGE CMP (CORRUGATED METAL PIPE) MINIMUM
 - > 2' HDPE (HIGH DENSITY POLYETHYLENE) MAY BE USED
- *CMP INDICATES CORRUGATED METAL CONCRETE OR HDPE PIPE MAY BE USED.**
 *CP INDICATES CONCRETE PIPE OR HDPE PIPE MAY BE USED.
 *RCP INDICATES REINFORCED CONCRETE PIPE IS REQUIRED.
- B. CONCRETE 6" THRU 21" DIAMETER PIPE SHALL BE NON-REINFORCED, BELL AND SPIGOT WITH RUBBER GASKET JOINTS, CONFORMING TO ASTM C14 OR CONCRETE 12" THRU 21" DIAMETER PIPE MAY BE REINFORCED, BELL AND SPIGOT WITH RUBBER GASKET JOINTS, CONFORMING TO ASTM C76 CLASS II.
- C. HIGH DENSITY POLYETHYLENE (HDPE) 12" THROUGH 24" DIAMETER PIPE SHALL BE CORRUGATED EXTERIOR/SMOOTH INTERIOR CONFORMING TO AASHTO M28 TYPE S. PIPE SHALL CONFORM TO ASTM D3502. FITTINGS SHALL CONFORM TO ASTM F1336

